

REVISIONS	BY

**GENERAL NOTES:**  
 Foundation walls to be 9'-0" TOP to TOW, Finish basement height to be 8'-7 1/2"  
 Basement windows to be set with bottom of clear opening 42" max. above finish floor.  
 Area wells to provide for full opening of windows and stepped egress, or have integral ladders.  
 Window wells are diagramatic, see detail for dimensions.  
 Basement Stair:  
 16 risers at 7 1/4" & 14 re treads @ 10" Verify exact fir. to fir. dimension.  
 Floor elevations as shown on siteplan.  
 Install underslab plumbing for future both.

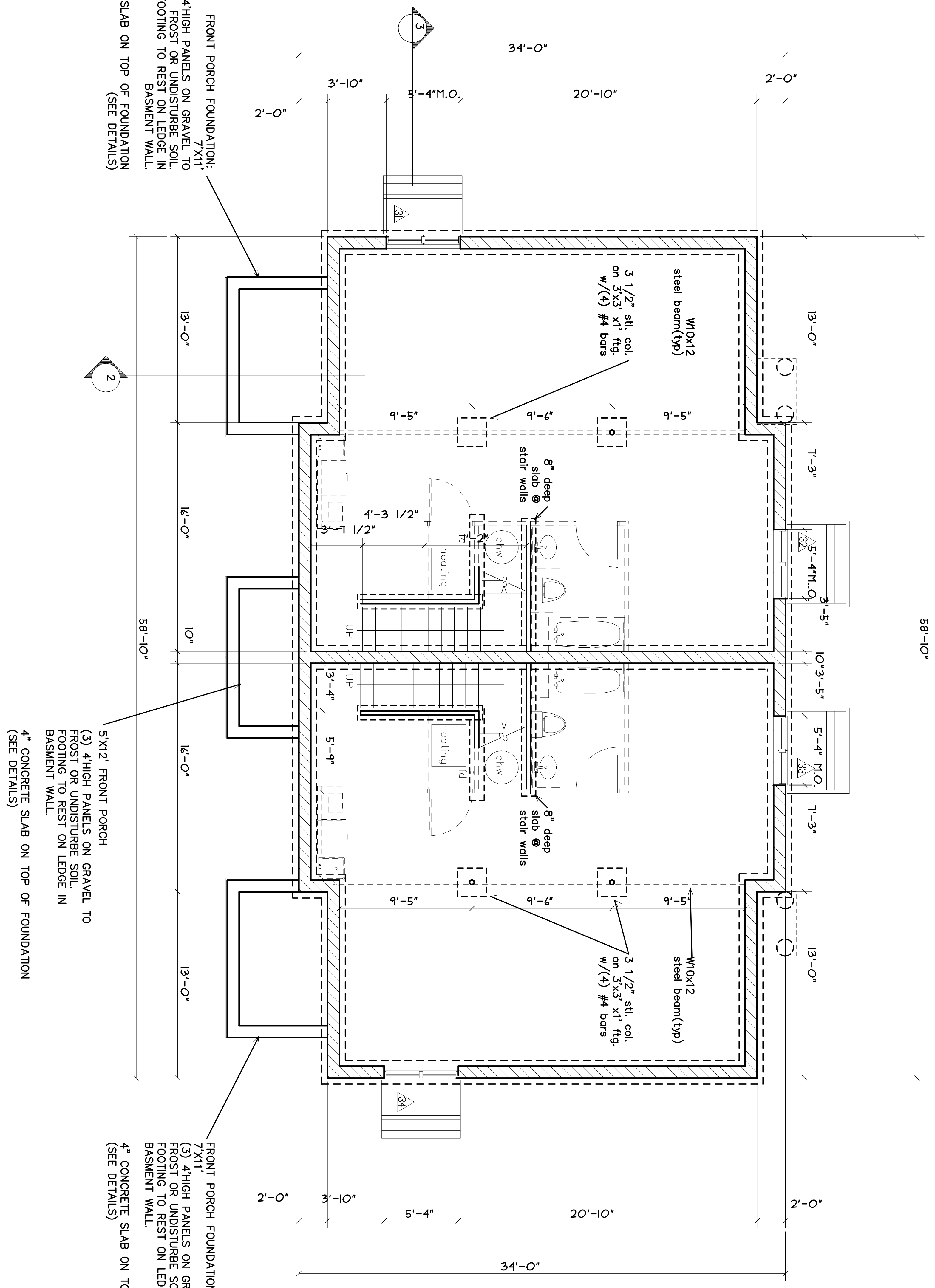

BASEMENT PLAN  
 AA'A'A UNIT(1total)

DRAWN : w/a	CHECKED : w/a
DATE : 3/11/2002	
SCALE : 1/4"=1'-0"	
JOB NO. :	
SHEET	

Great Oak CoHousing of Ann Arbor  
 LITTLE LAKE DRIVE, SCIO TWSHP, MI

**Sunstructures Architects**  
 201 East Liberty St, Ann Arbor, MI 48104 (734) 994-5650 fax (734) 994-5656

Basement Plan